

# FUEL PRO® 487

## PRODUCT DATA SHEET

The **FUEL PRO® 487** is an all-in-one fuel filter, water separator, and fuel pre-heater for heavy duty on-highway diesel engines with flow rates up to 180 gallons per hour.

With an optional pre-heater, overnight heater, and water-in-fuel sensor, the Fuel Pro® 487 will keep the engine running in any weather conditions.

Three layer filter design, with filtration to 10 microns, provides enhanced water separation capabilities for ultra-low sulfur diesel fuel with low interfacial tension.

### Applications

- Detroit DD13, DD15, DD16
- All Freightliner/Western Star Chassis except Cascadia NGC

### Options

- Base model: unheated
- Electric heat
  - 12VDC or 24VDC Pre-heater
  - 120VAC Overnight heater
- Water-In-Fuel (WIF) sensor (standard when used with Cummins X15 Engines)

### Benefits

- Seeing is Believing® - see when NOT to change your filter
- Protects diesel engines from contaminants
- Reduces maintenance downtime
- Visual troubleshooting
- Environmentally friendly filter change
- Simple filter priming for easier starts
- Biodiesel up to B20 compatible

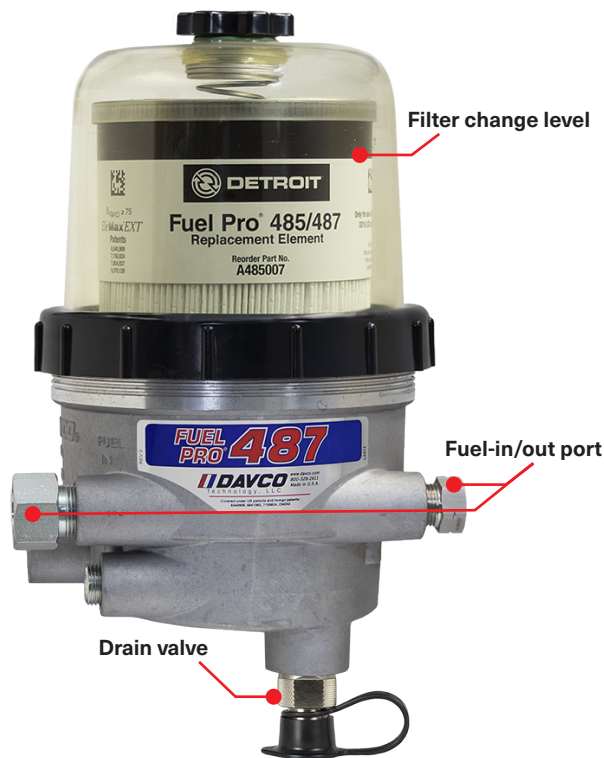

### Filter Technology

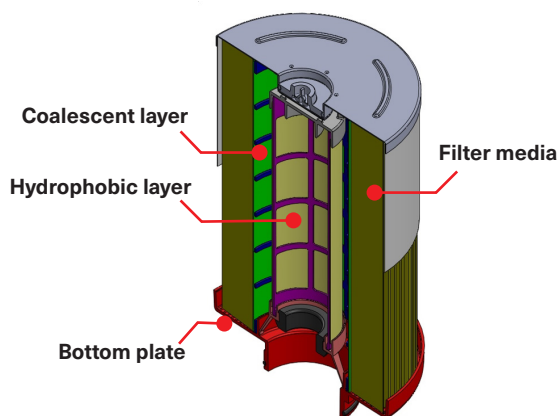

A Clariance Technologies Company

800-328-2611

customerservice@davco.com

www.davco.com

F3519 REV F | Updated on 05/05/2026

# FUEL PRO® 487

## Specifications

Height, overall, unheated model	14.68 in. (372.87 mm)
Depth, overall	9.92 in. (252 mm)
Width, maximum	8.35 in. (212.1 mm)
Weight, dry	Approx. 11 lbs
Minimum service height	4 in. (101.6 mm)
Max fuel flow	180 gph
Pre-heater	12VDC (150W) or 24VDC (135W)
Overnight heater	120VAC, 75W, .65A

## Filtration Performance (10 micron at 174 GPH)

Micron	10
Coarse water removal (%)	>99%
Emulsified water removal (%)	>93%
% Emulsified water removal (end of life filter)	>80%
Dirt holding capacity (grams)	150

## Port Interface

Fuel-in	½"-14 NPTF or M22 x 1.5-6H (DTNA)
Fuel-out	½"-14 NPTF or M22 x 1.5-6H (DTNA)

## Dimensions

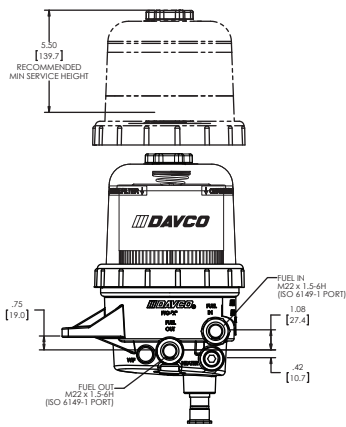

LEFT

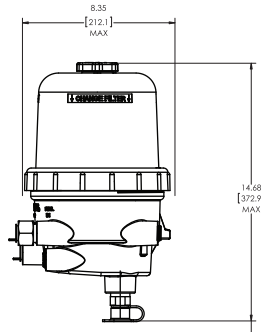

FRONT

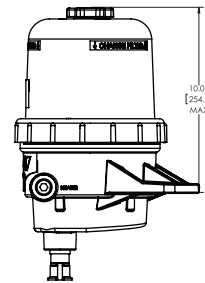

RIGHT

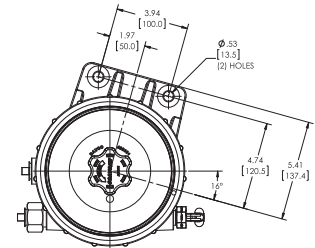

TOP

Mounting hole distance: 3.963 in. [99.9 mm]  
Mounting hole openings: .531 in. [13.05 mm]

## SALES CODES

### Detroit Engines

Sales Codes	DAVCO Part #	Description
122-1K3	487950FTL-08	Fuel Pro 487
122-1K4	487952FTL-08	Fuel Pro 487 with 195W 12VDC Pre-heater
122-1K5	487962FTL-08	Fuel Pro 487 with 195W 12VDC Pre-heater and 120VAC Overnight heater
122-1K6	487950FTLE-08	Fuel Pro 487 with Black Band, Red Stripe Cover
122-1K7	487952FTLE-08	Fuel Pro 487 with 195W 12VDC Pre-heater and Black Band, Red Stripe Cover
122-1K8	487962FTLE-08	Fuel Pro 487 with 195W 12VDC Pre-heater, 120VAC Overnight heater, and Black Band, Red Stripe Cover

Replacement Filter:

Fleetguard part number: FS20083

Detroit Diesel part number: A0000905051

## DAVCO Technology, LLC

All statements are based on OEM fuel quality requirements. Contact your DAVCO RSM for OEM specific warranties.

© 2025 DAVCO Technology, LLC. DAVCO is a subsidiary of Clariance Technologies. All rights reserved.

